

# BIM 2021

**WIT**  
CONFERENCES  
Call for Papers

**4<sup>th</sup> International Conference on Building Information Modelling (BIM) in Design, Construction and Operations**

**8 – 10 September 2021 | Santiago de Compostela, Spain**

**Organised by**

University of the West of England, UK

University of Alicante, Spain

Wessex Institute, UK

**Sponsored by**

WIT Transactions on the Built Environment



[www.witconferences.com/bim2021](http://www.witconferences.com/bim2021)

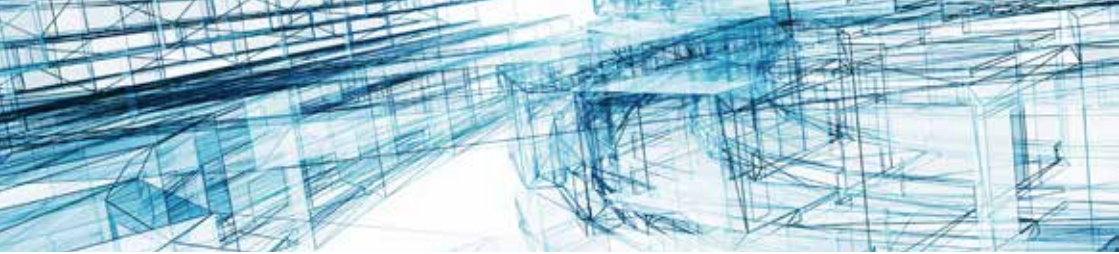

The first International Conference on Building Information Modelling (BIM) in Design, Construction and Operations took place in Bristol, UK in 2015 and has since been reconvened in Alicante, Spain (2017) and Seville, Spain (2019).

The modern construction industry and built environment disciplines have been transformed through the development of new and innovative BIM tools and techniques. These have fundamentally altered the manner in which construction teams operate; the processes through which designs are evolved; and the relationships between conceptual, detail, construction and life cycle stages.

BIM is essentially value-creating collaboration throughout the entire life-cycle of an asset, underpinned by the data attached to them. BIM has far and reaching consequences on both building procurement and infrastructure.

This recent emergence constitutes one of the most exciting developments in the field of the Built Environment. These advances have offered project teams multi-sensory collaborative tools and opportunities for new communication structures.

The conference fulfils the vital task of bringing together experts from industry, practice and academia to debate those key topics, to develop innovative solutions, and predict future trends. The conference includes a range of presentation forums, including plenary papers, workshops, seminars, and panel sessions.

Papers presented at this conference series as well as others sponsored by the Wessex Institute are permanently available to the International Scientific Community through the e-library of the Institute <https://www.witpress.com/elibrary>

## Conference Chairmen

### **Juan Casares**

University of Santiago de Compostela, Spain  
*Member of WIT Board of Directors*

### **Lamine Mahdjoubi**

University of the West of England, UK

### **Antonio Galiano Garrigos**

University of Alicante, Spain

## International Scientific Advisory Committee

### **Maria Dolores Andujar Montoya**

Universidad de Alicante, Spain

### **Roque Angulo Fornos**

University of Seville, Spain

### **Yi-Jao Chen**

National University of Kaohsiung, Taiwan

### **Clark Cory**

Purdue University, USA

### **Fabrizio Cumo**

University of Rome 'La Sapienza', Italy

### **Fodil Fadli**

Qatar University, Qatar

### **Fabio Garzia**

University of Rome 'La Sapienza', Italy

### **James Harty**

Copenhagen School of Design & Technology, Denmark

### **Eilif Hjelseth**

Norwegian University of Science and Technology, Norway

### **Richard Laing**

Robert Gordon University, UK

### **Yaik Wah Lim**

Universiti Teknologi Malaysia, Malaysia

### **Mohamed Mohsen**

Engineering Consultants Group, Qatar

### **Felipe Munoz**

Pontifical Catholic University of Valparaiso, Chile

### **Juan Carlos Pomares Torres**

University of Alicante, Spain

### **Noha Saleeb**

Middlesex University, UK

### **Hugo Sheward**

University of Kansas, USA

### **Paul Stephenson**

Sheffield Hallam University, UK

### **Marek Suchocki**

Autodesk, UK

### **Kwok Wai Johnny Wong**

University of Technology Sydney, Australia

## Benefits of Attending

### USB Drive

Delegates will receive a USB drive at the conference containing the presented papers.

### Publication

Papers presented at BIM 2021 are to be published in a Volume of WIT Transactions on the Built Environment (ISSN 1743-3509). The publication will be available in both electronic and hard copy.

### Indexing

The WIT Transactions are DOI registered with CrossRef and are currently listed in indexing services such as Scopus and Google Scholar, as well as being submitted to the Web of Science. All conference books are listed in the British Library and American Library of Congress.

### Open Access and Digital Archive

All conference papers are archived permanently on our electronic library where they can be downloaded for free. ([www.witpress.com/elibrary](http://www.witpress.com/elibrary))

### Peer Review

To ensure the quality of our publications, abstracts and papers are double peer-reviewed by members of the International Scientific Advisory Committee and other experts, with manuscripts processed through CrossRef Similarity Check to screen for plagiarism.

### Reduced Fee for PhD Students

The Wessex Institute believes in the importance of encouraging PhD students to present and publish innovative research at its conferences. As a result, the Institute offers PhD students a much-reduced conference fee.

### Networking

Participants can present their research and interact with experts from around the world, as part of a unique community.

### Journal Publication Opportunity

After the conference, delegates will be invited to submit an enhanced version of their conference paper to one of the WIT Press International Journals.

## Conference Topics

The following list covers some of the topics to be presented at the conference. Papers on other subjects related to the objectives of the meeting are also welcome.

### BIM in design coordination

### BIM in construction operations

### BIM in building operation and maintenance

### BIM and sustainability

### BIM and collaborative working and practices

### BIM-Facilities management integration

### BIM-GIS integration

### BIM and automation in construction

### BIM and health and safety

### BIM standards

### BIM and interoperability

### BIM and life cycle project management

### BIM and cultural heritage

### BIM and robotics

### BIM in risk analysis and management

### BIM in building cost control

### BIM and building representation

### Virtual design and construction (VDC)

### BIM in the execution phase

### BIM for infrastructure development

### Case Studies





© Bene Riobó

## Location

Situated in the northwest coast of Spain, Santiago de Compostela is the capital of the autonomous region of Galicia. The city is known worldwide for being the culmination of Saint James Pilgrimage (“El Camino”), a religious tradition which dates back to the middle ages. Hundreds of thousands of visitors arrive in Santiago de Compostela every year attracted not only by its religious importance but for its cultural richness. Santiago’s unparalleled series of monuments, monasteries, churches, palaces, old streets and typical popular constructions, combined with its spiritual and cultural significance, have given it its deserved inclusion in the list of World Heritage Cities.

**Santiago’s Cathedral:** Built over several centuries, its beauty is a mix of an original Romanesque structure (constructed between 1075 and 1211) and later Gothic and baroque flourishes. The cathedral’s artistic high point is the “Pórtico de la Gloria” (Portico of Glory) inside the west entrance, featuring 200 masterly Romanesque sculptures.

## Venue

The conference will take place at the University of Santiago de Compostela. With a history of more than 500 years, the University of Santiago de Compostela has grown to become one of the most important universities of Spain, attracting more than 25,000 students every year. The university has several campuses located around the city within walking distance from the Cathedral.



## Submission Information

**Abstracts of no more than 300 words should be submitted as soon as possible.**

Abstracts should clearly state the purpose, results and conclusions of the work to be described in the final paper. Final acceptance will be based on the full-length paper which, if accepted for publication, must be presented at the conference.

The language of the conference will be English.

### Online submission:

[www.witconferences.com/bim2021](http://www.witconferences.com/bim2021)

### Conference Secretariat

Irene Moreno Millan  
[imoreno@wessex.ac.uk](mailto:imoreno@wessex.ac.uk)

### Wessex Institute

Ashurst Lodge, Ashurst  
Southampton, SO40 7AA, UK

Tel: +44 (0) 238 029 3223  
Fax: +44 (0) 238 029 2853



For more information visit: [www.witconferences.com/bim2021](http://www.witconferences.com/bim2021)